



Northam Park Athletic Fields & Tennis Study

July 29, 2020



Introduction

2018 - Parks & Recreation Comprehensive Plan made several recommendations for Northam Park

- Consider renovation of park service building
- Consider adding a park shelter and year round restrooms for public use
- Develop a plan to address how to maximize athletic facilities
- Develop and implement a drainage plan
- Develop a plan to maximize field use
- Determine appropriate renovation of Northam Tennis

2019 - MSA Sport selected to lead schematic design study of potential improvements to athletic and tennis complex.







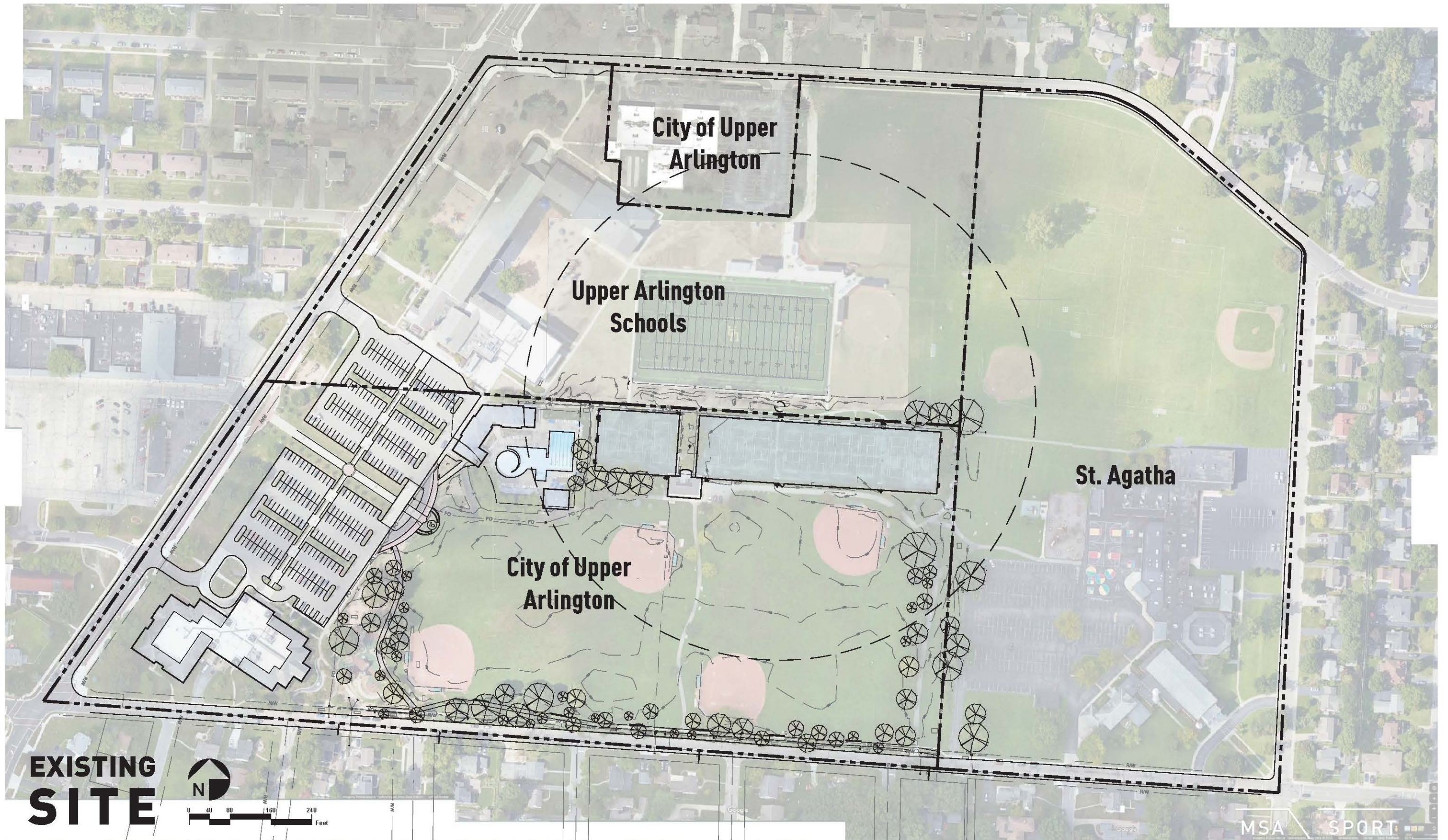



Measures of Success:

- Study will provide a long term plan with cost estimates for potential park improvements
- Given the well-established uses of the park, the process will focus on renovations or replacement of facilities that support these existing uses
- Study will be mindful of existing trees and other established park amenities
- Study will make recommendations to improve the physical infrastructure of the park
- Provide recommendations for improving support buildings





2020

	JAN	FEB	MAR	APR	MAY	JUN	JUL	AUG	SEP	OCT
PROJECT KICKOFF										
INITIAL GROUP MEETINGS										
SITE VISIT TO SCIOTO COUNTRY CLUB										
SITE SURVEY										
MEETINGS WITH CLAY COURT VENDORS										
DEVELOPMENT OF CONCEPTS										
REFINEMENT OF CONCEPTS										
GROUP MEETINGS/ COMMUNITY MEETINGS										
ONLINE SURVEY										
PREFERRED CONCEPT PLAN DEVELOPED										
FINAL CONCEPT PLAN										

Feedback from Initial Group Meetings

Groups:

- City and Civic Event Organizers
- Athletics
- Tennis
- Neighbors

Questions:

- What is working?
- What is not working?
- What do you want to see happen?

What is Not Working?

- Distribution of utilities (water, power) can be limiting
- Heavy equipment can create damage to fields/lawns
- Condition of support spaces (restrooms, tennis office) is poor
- Shade trees within tennis courts are problematic for court condition
- Pedestrian walking paths; circulation (pedestrian and vehicles) within the park
- Support amenities that serve park are lacking, including storage, restrooms, drinking fountains
- No defined gathering areas or protected areas for athletes
- Condition of existing turf (grading, location of catch basins, drainage, and lack of irrigation) – no time for the grass to rest

What is Working?

- Ability to accommodate civic events
- Flexible, open space in center of park
- Location, quantity, and quality of tennis courts
- Reputation of programs and staff at tennis courts
- The park identity as a community park
- Recent improvements (pool and playground) have been a positive addition
- Centralized location within Upper Arlington with easy access for walking, biking, and cars
- Quantity of athletic fields

What do You Want to See Happen?

- Engagement of the “edges”, including adjacent properties; maximize use of Northam Road
- Incorporate provisions for a stage/pavilion and utilities
- Improved circulation at the tennis courts – both around courts and within perimeter of fence
- Improved drainage and irrigation of courts
- Improved drainage and condition of athletic fields
- Preserve open green space and existing trees
- Additional shelter space
- Improved park services including restrooms and storage

- New centralized sewer trunk with collector branch sewer lines off of main trunk
- Locate catch basin structures outside of playing fields
- Possible stormwater detention located under field/s
- Raise tennis complex approx. 6" in elevation; add irrigation for clay courts
- Add underdrains and irrigation for athletic fields
- Existing flood route through site to be reworked as needed
- Provide additional water and electric at locations throughout site

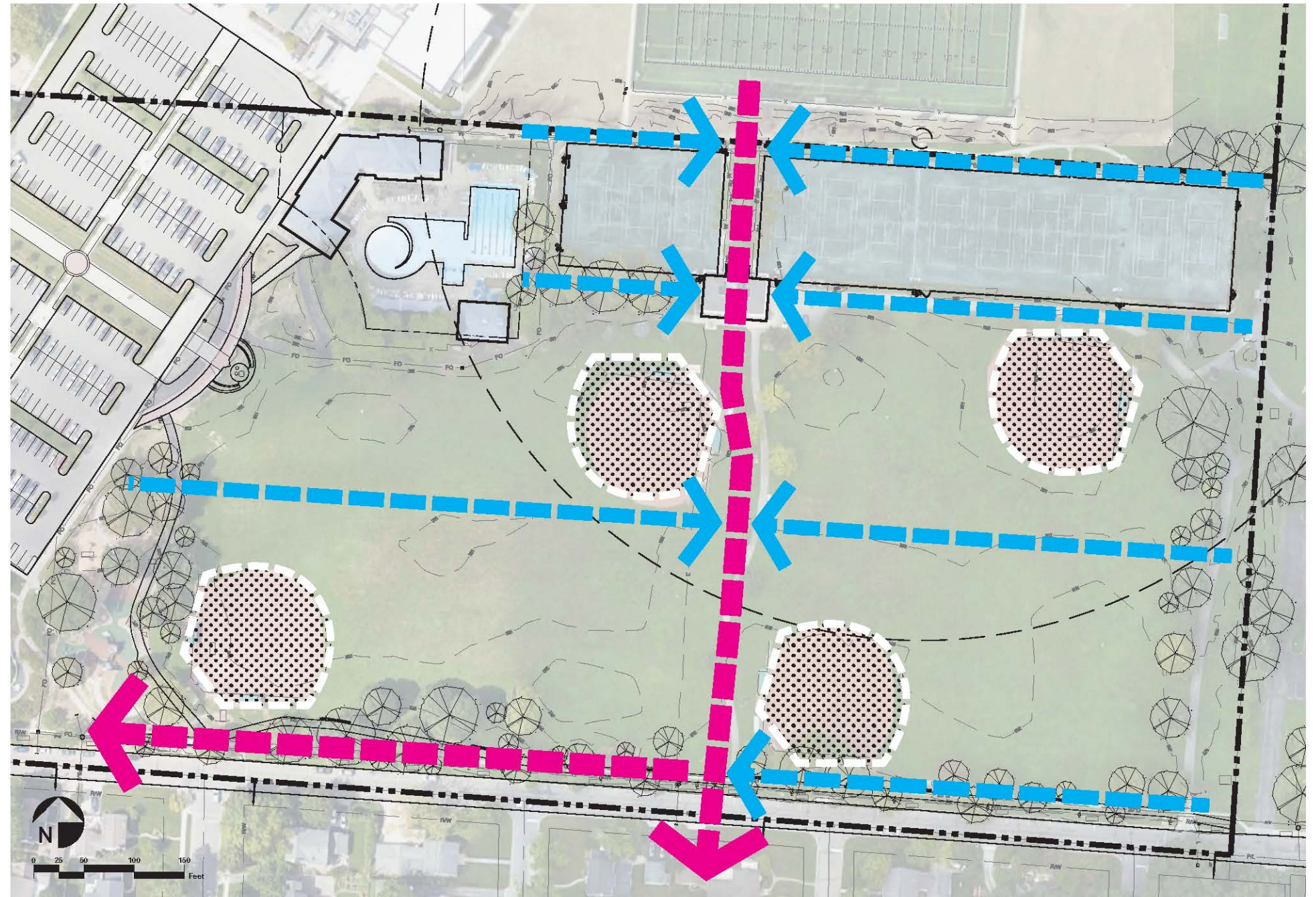

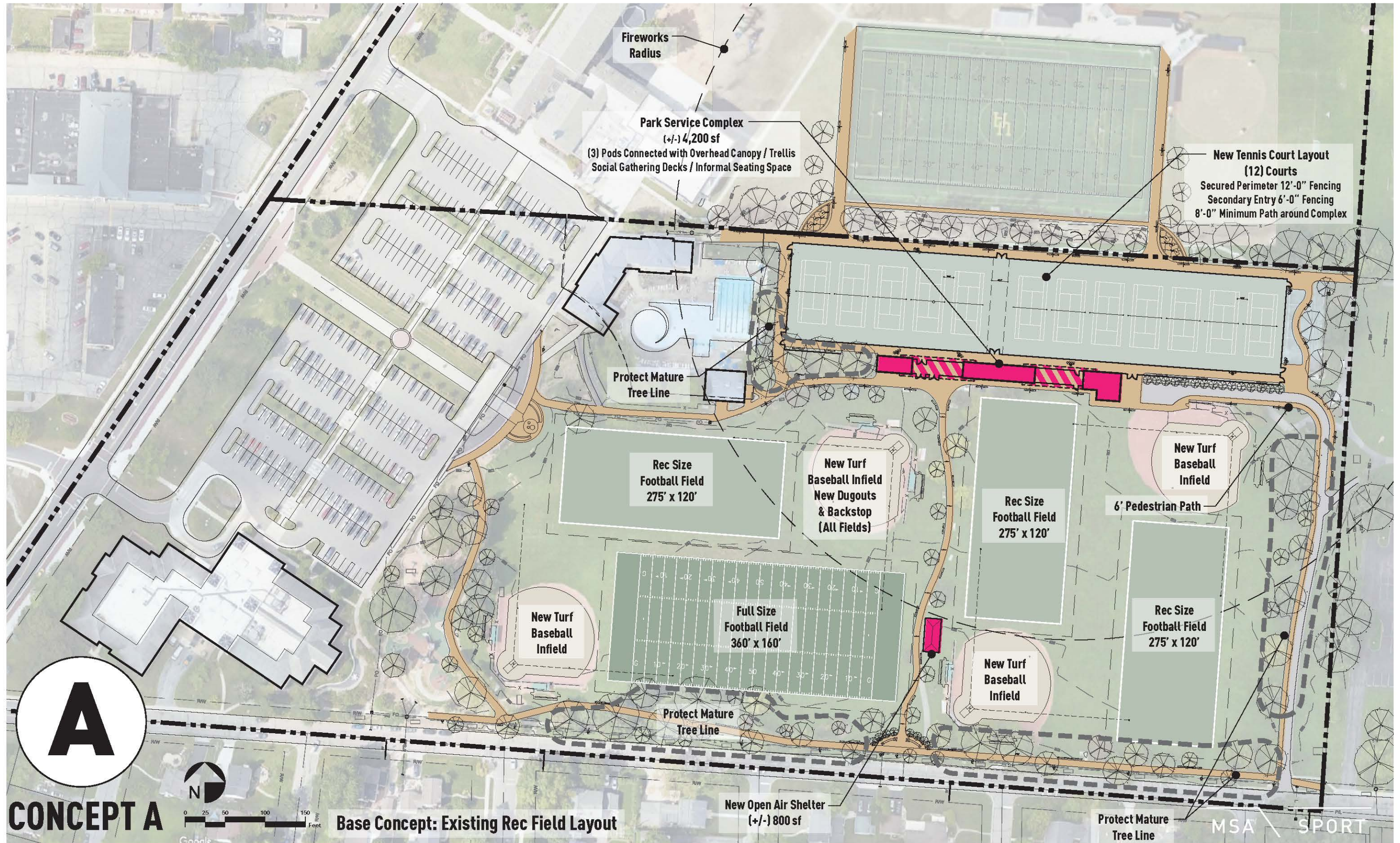

CONCEPT A

Base Concept: Existing Rec Field Layout

MSA SPORT

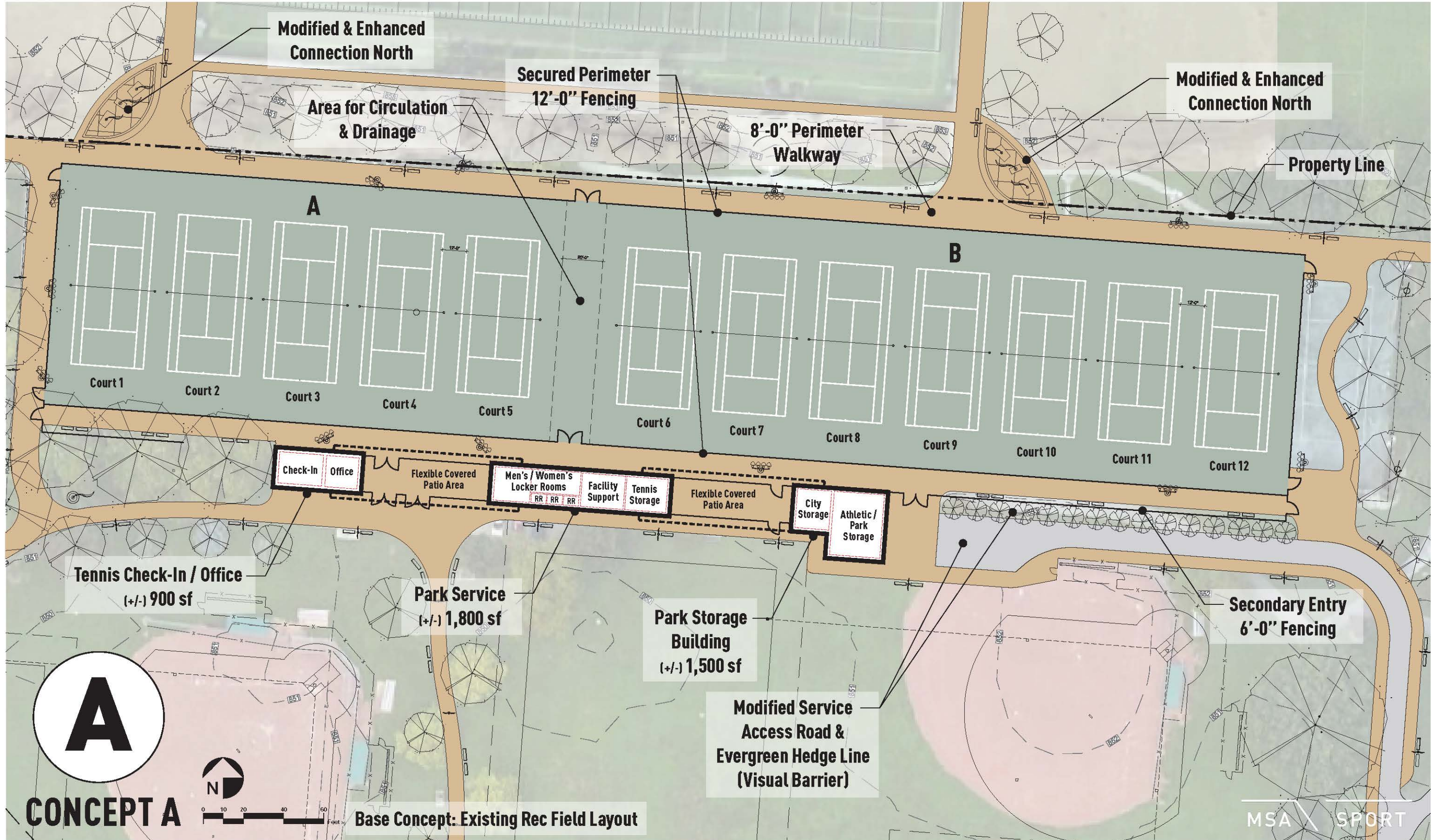

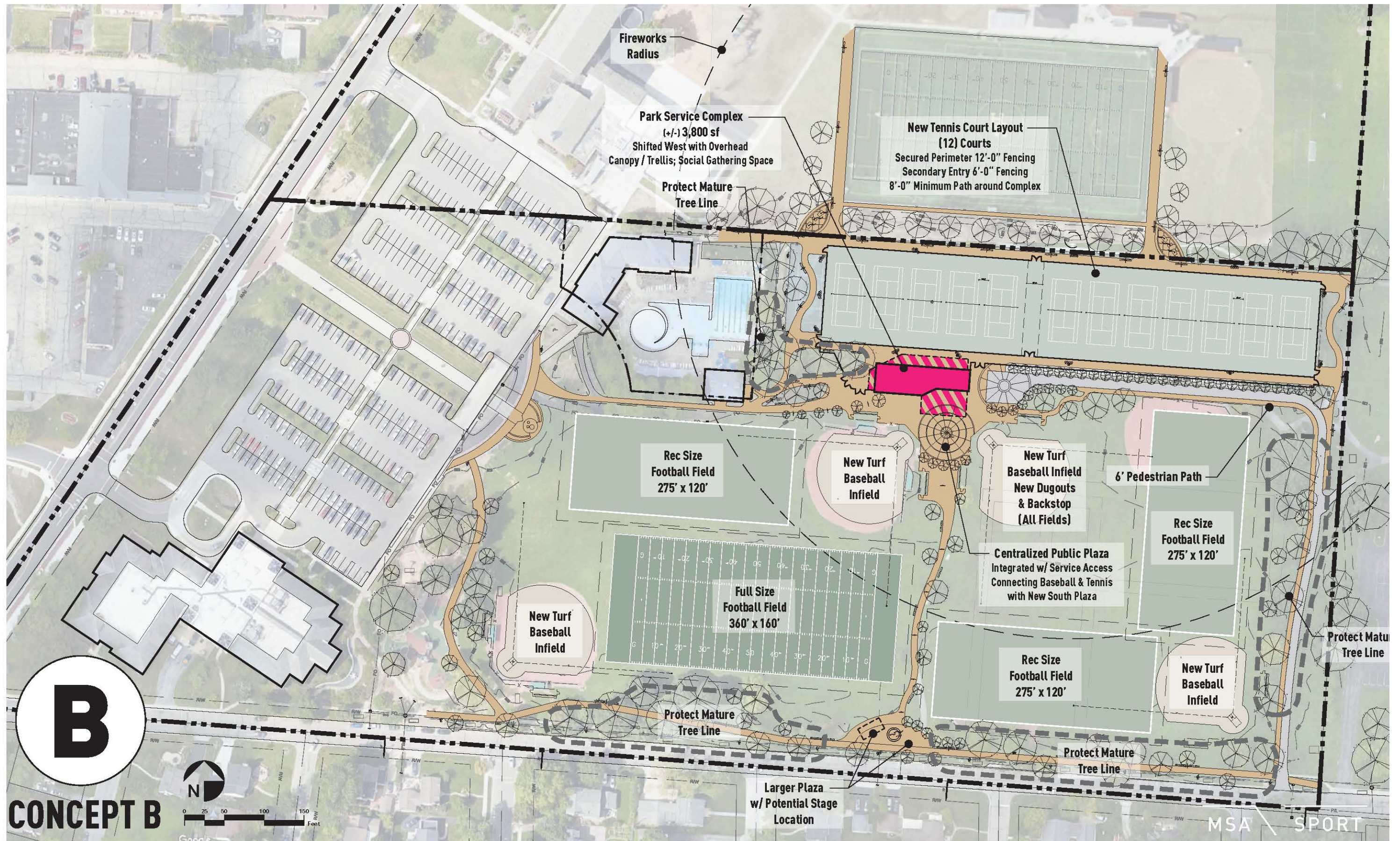

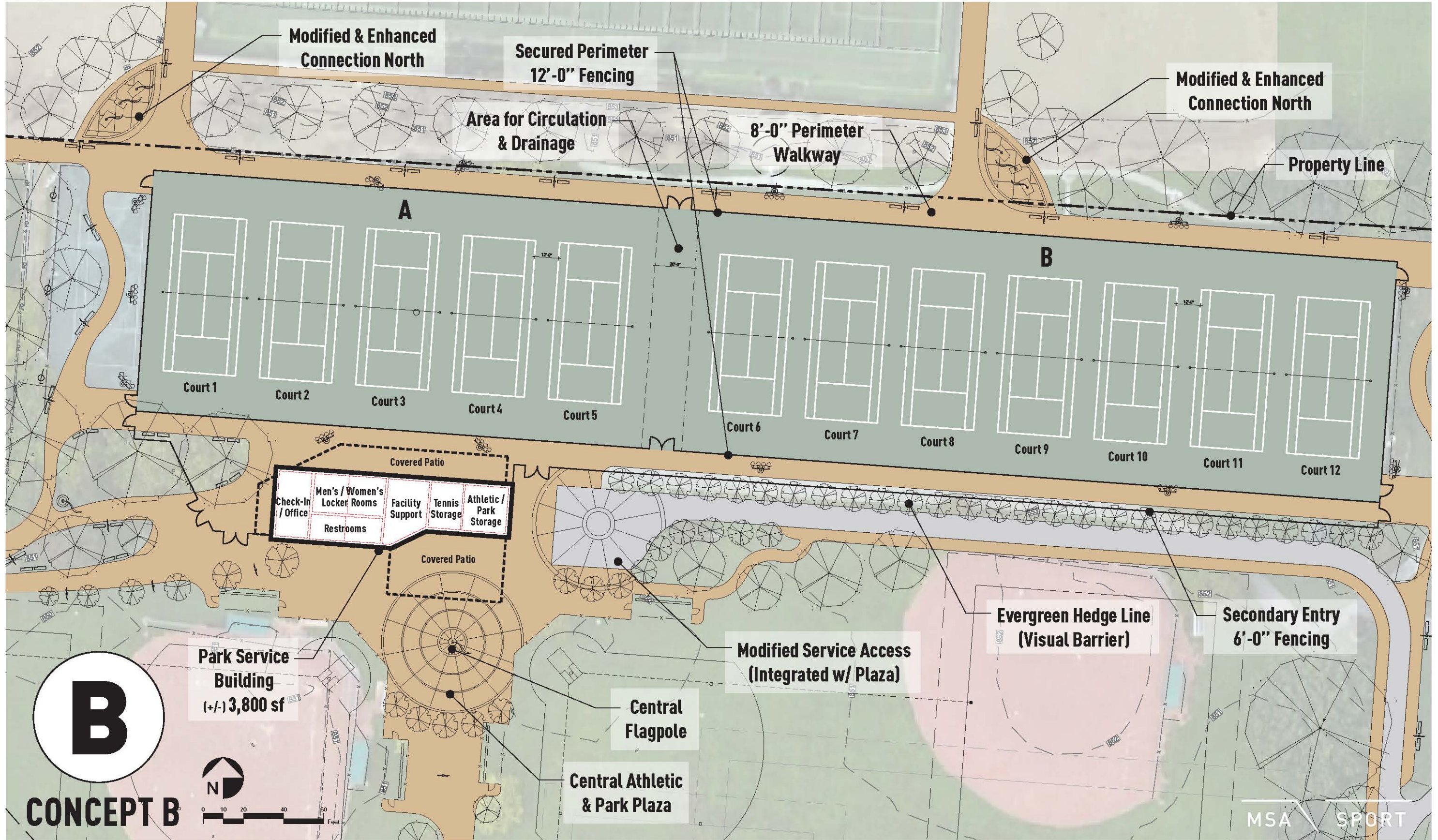

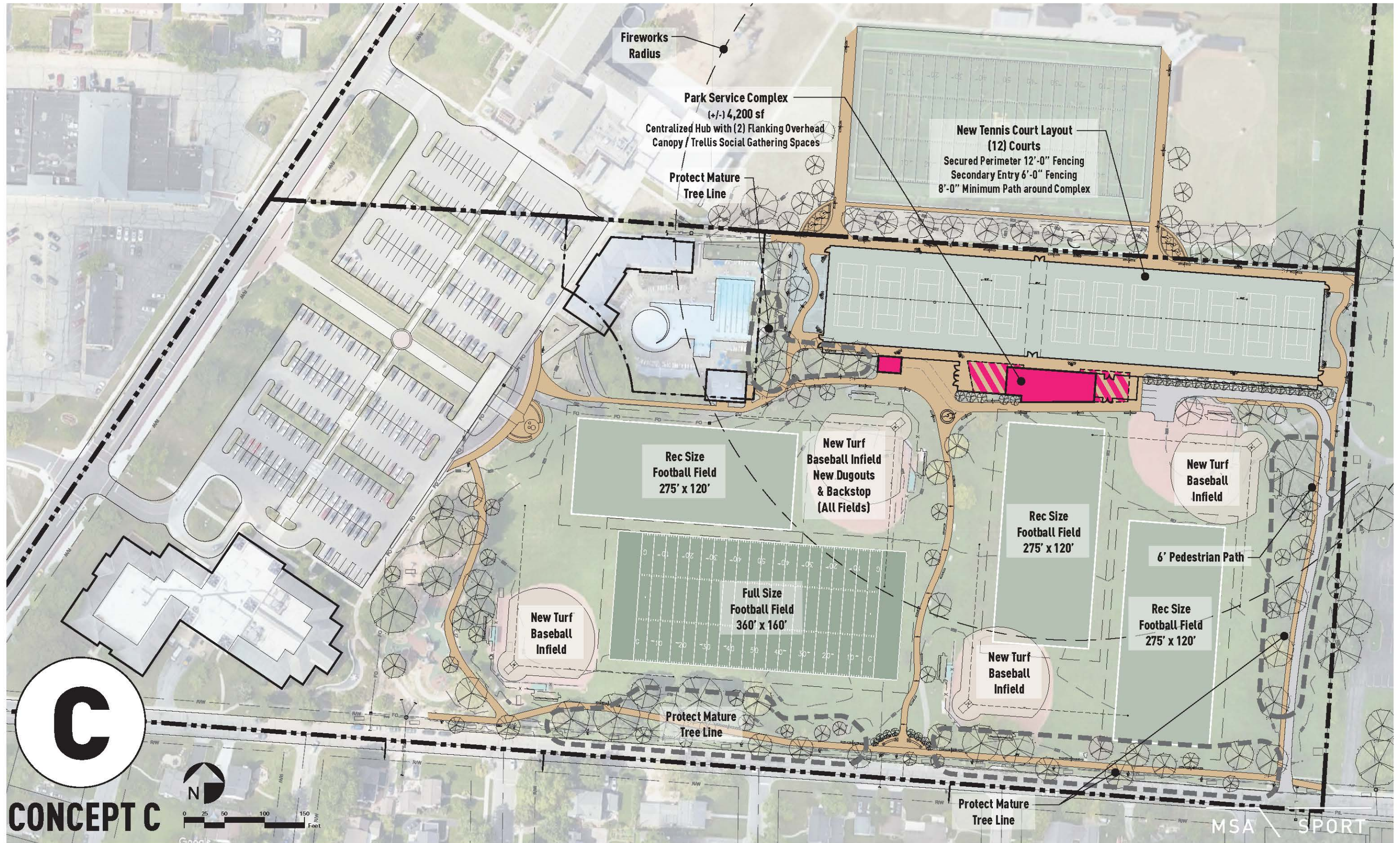

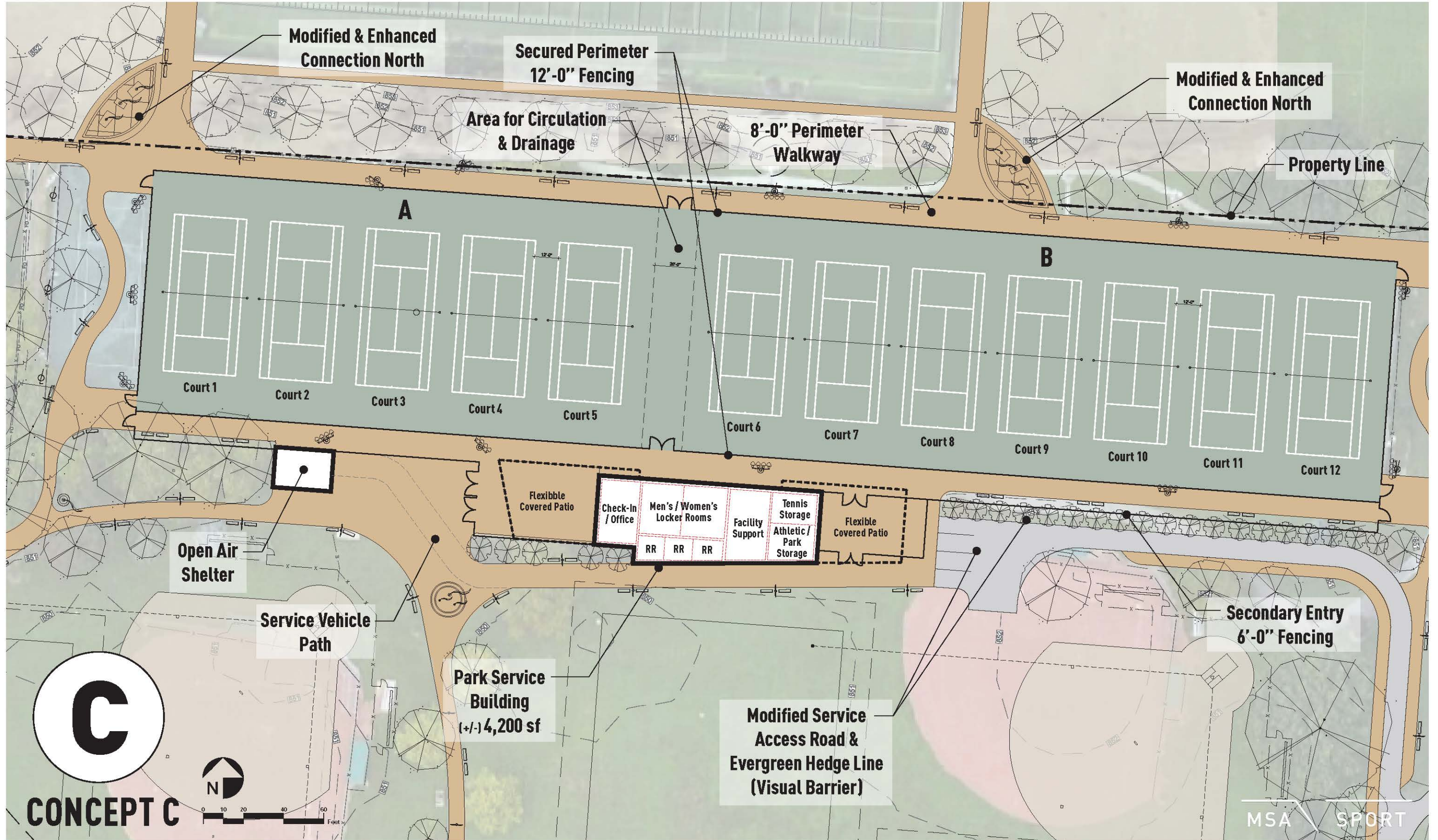

C

CONCEPT C

TO NOTE: ALL GATES AROUND PATIO SPACES SHOULD BE CONSIDERED FLEXIBLE: SLIDING, FOLDING, OR GENERAL RETRACTABILITY.

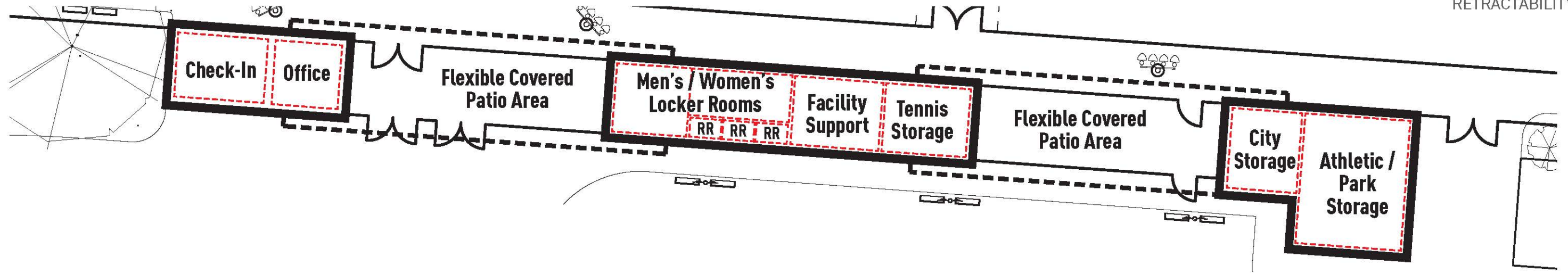

BUILDING PODS WITH CONNECTING OVERHEAD CANOPIES

0 2 4 8 16 Feet

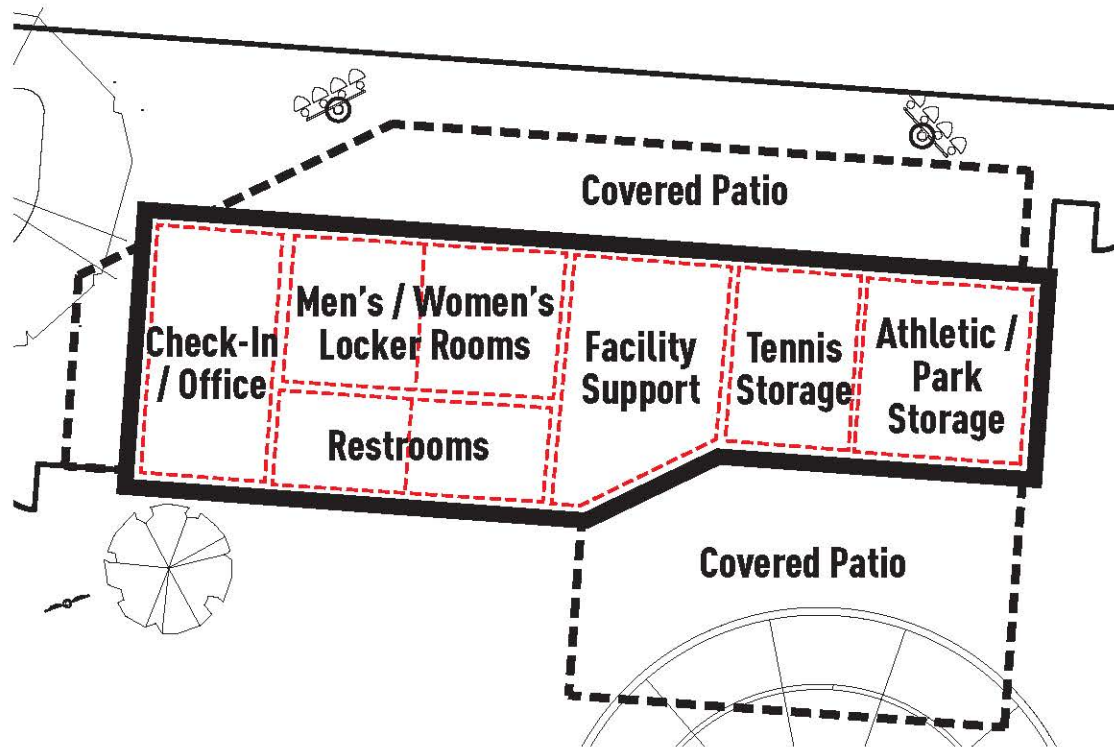

SINGLE BUILDING WITH NORTH / SOUTH COVERED PATIOS

0 2 4 8 16 Feet

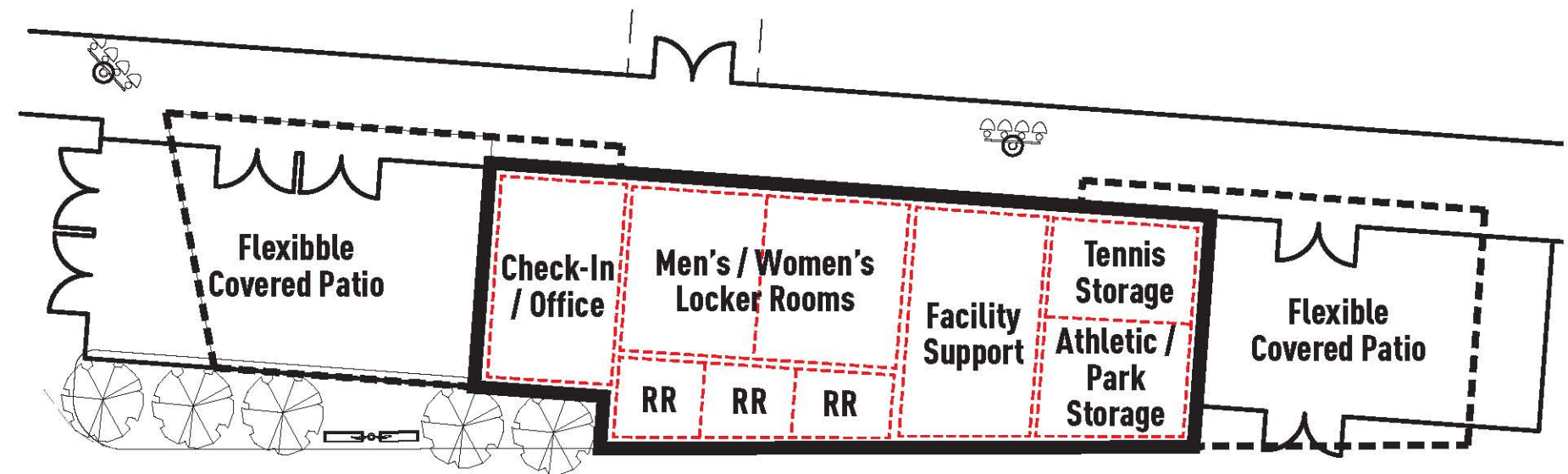

SINGLE BUILDING WITH EAST / WEST COVERED PATIOS

0 2 4 8 16 Feet



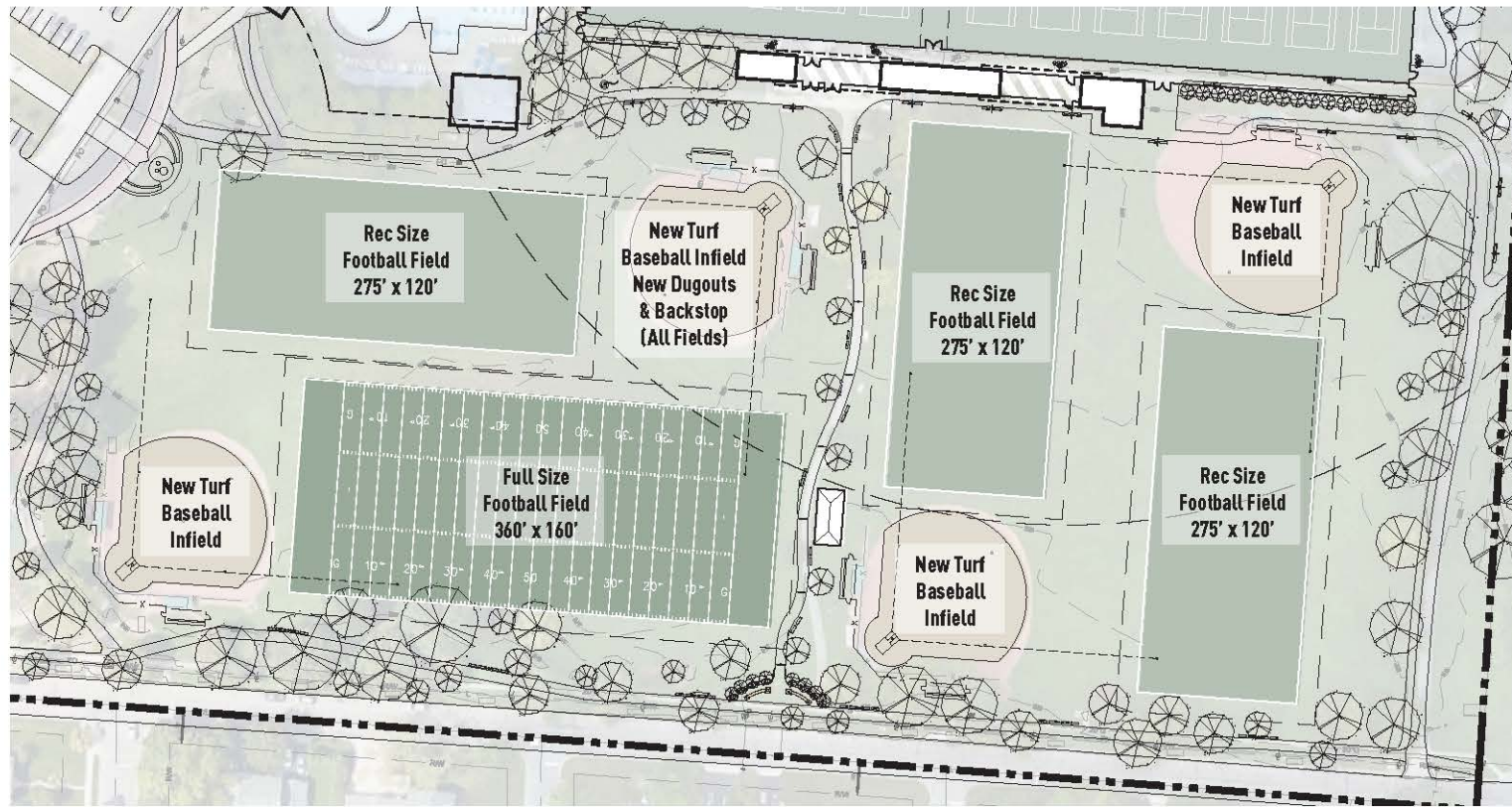

CONCEPT A & C

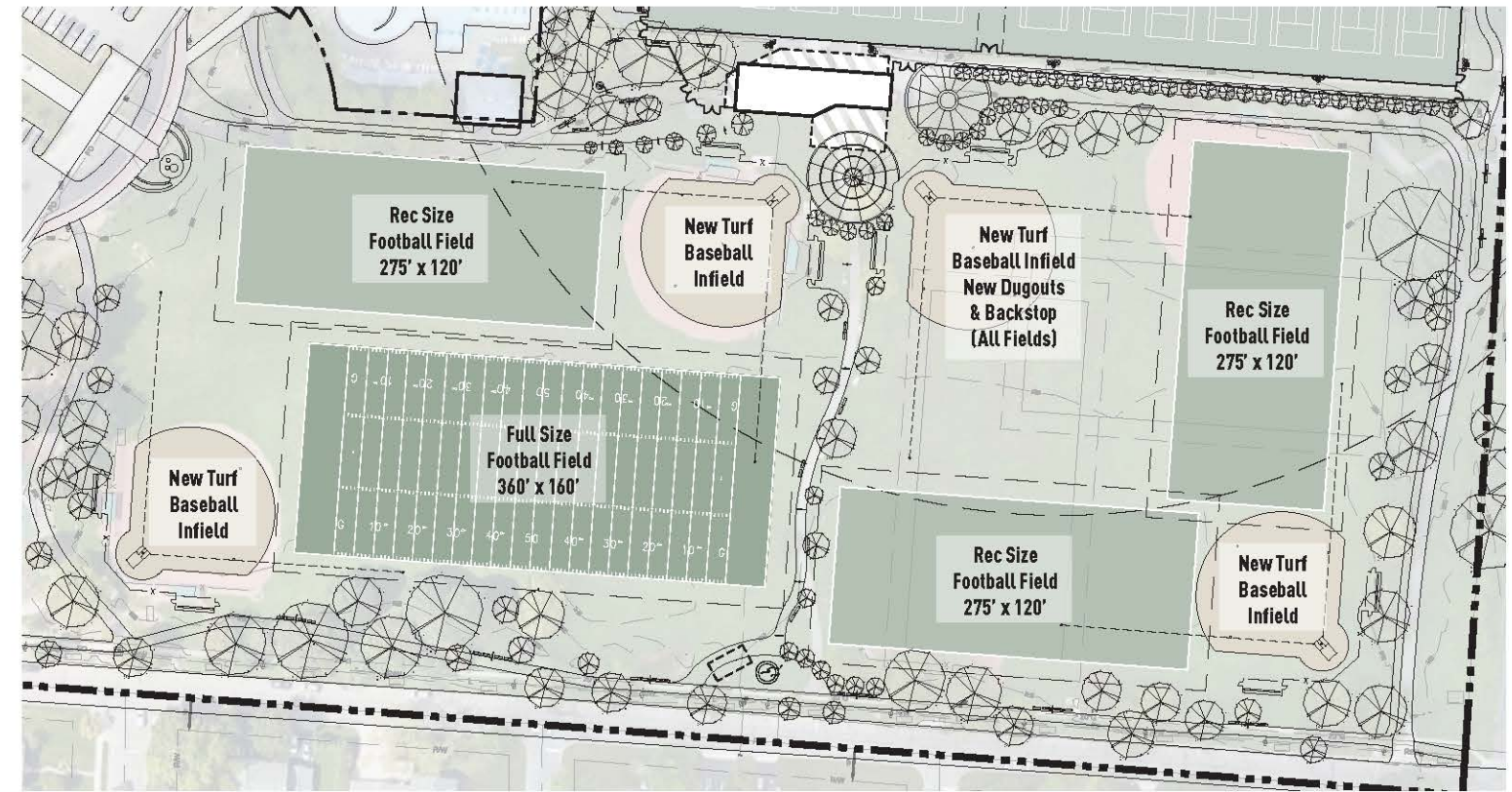

CONCEPT B

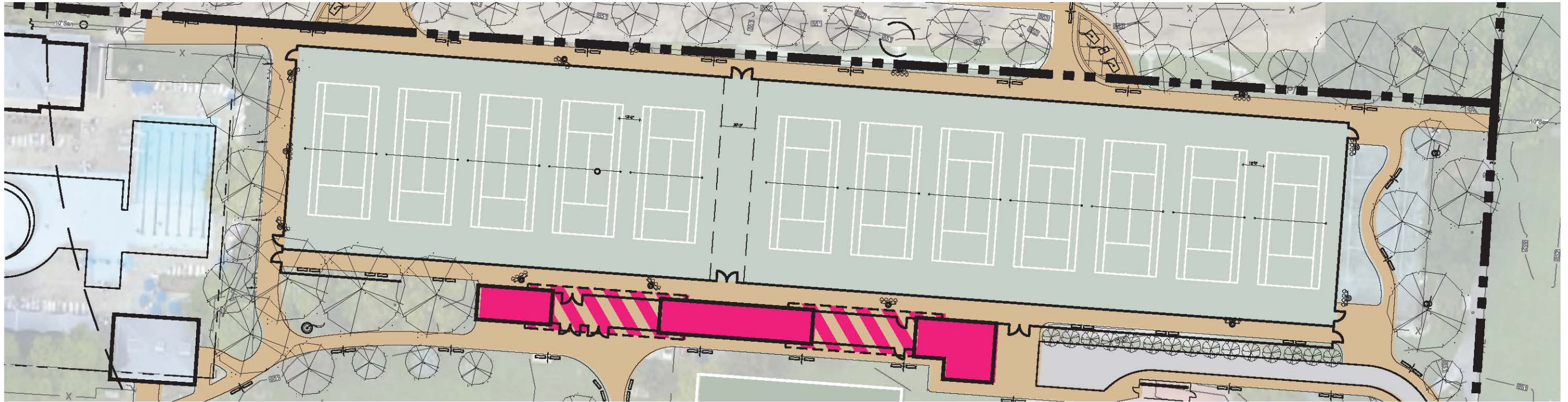

WESTERN JUSTIFIED COURTS - PROVIDING MORE BUFFER BETWEEN TENNIS COURTS AND CHURCH PROPERTY

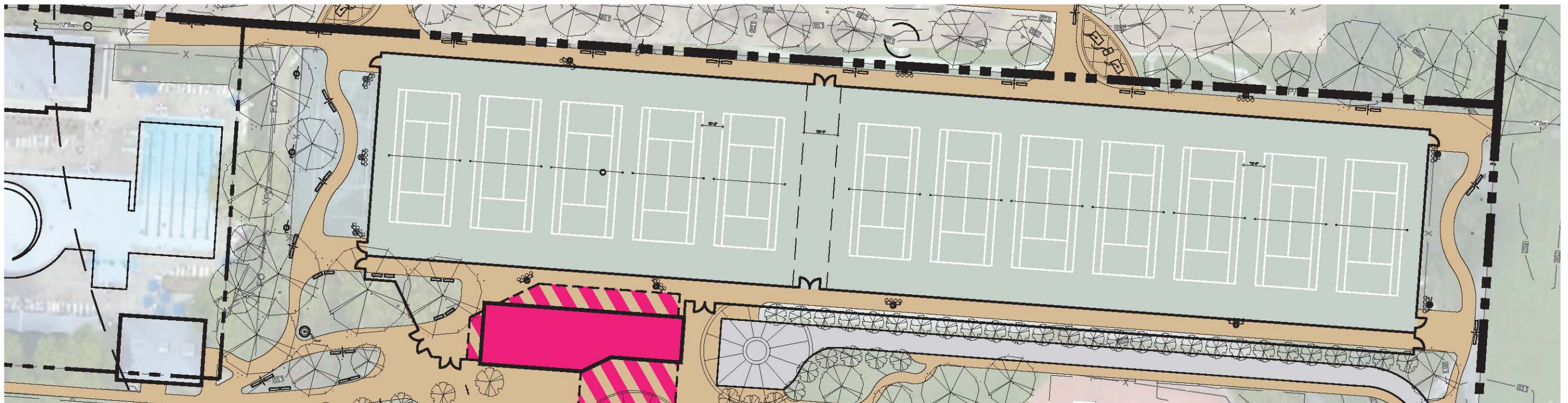

EASTERN JUSTIFIED COURTS - PROVIDING MORE BUFFER BETWEEN TENNIS COURTS AND POOL



Enlarged South Plaza

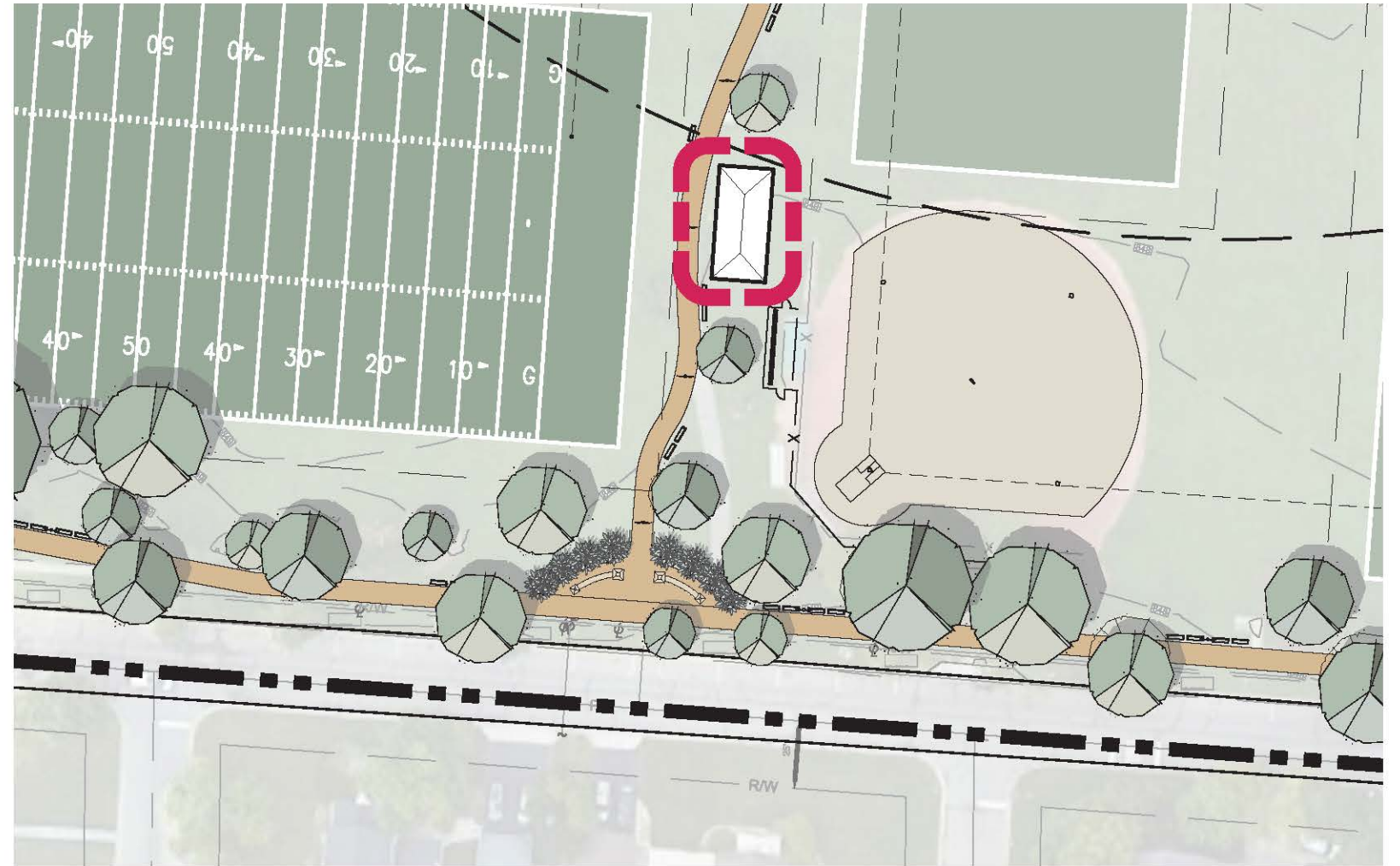

Open Air Athletic Shelter Located Outside Fireworks Radius



Next Steps:

July 29th - Community Meeting via ZOOM (6:30 PM)

July 30th to August 11th - Online Survey

September 2020 - Draft of Final Concept Plan shared with the Community

Fall 2020 - Final Concept Plan presented to City Council

Contact Us: parks@uaoh.net